

3 and 4 Row QuickShip Bleacher

Assembly Instructions

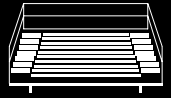

Instructions are applicable to all 3 and 4 row QuickShip Bleachers. Three row item numbers: 6A3S7.5, 6A3S15, 6A3S21, 6A3S27. Four row item numbers: 6A4S7.5, 6A4S15, 6A4S21, 6A4S27.

Step 1

Hardware, Parts, and Tools Needed

a. The hardware kit includes 3/8" x 1 1/2" galvanized washers, hex nuts, and bolts, 3/16" x 3/16" pop rivets. The hardware is individually packaged inside the crated box.

b. The parts include frames, horizontal sturt, tie down assemblies, 10" and 12" end caps, 10" mill finish foot deck plank, and 12" anodized seat plank.

c. The tools required to assembly your bleachers include:

- gloves
- safety glasses
- measuring tape
- rubber mallet
- screw gun with 1/4" nut driver
- SAE ratchet & socket set with 1/2" socket and 9/16" socket

Step 2

Preparation

a. Secure a location that is large enough for the assembly process. The assembly area must be level.

Step 3

Attach Horizontal Strut

a. Stand each frame up with approximately 6 feet of spacing between each frame. CAUTION: Do not leave frames in a "free-standing" position.

Step 3 (continued)

b. Insert 3/8" x 1 1/2" hex bolts through the frames as indicated in Figure 1. Each frame will accommodate two (2) bolts with a flat washer and hex nut for each bolt.

c. Hold on to each frame until the horizontal strut is in place, assistance from another person is recommended.

d. Place the horizontal strut on to the bottom rear of each frame. Secure each bolt with a flat washer and hex nut as indicated in Figure 1. Do not fully tighten until all bolts are in place.

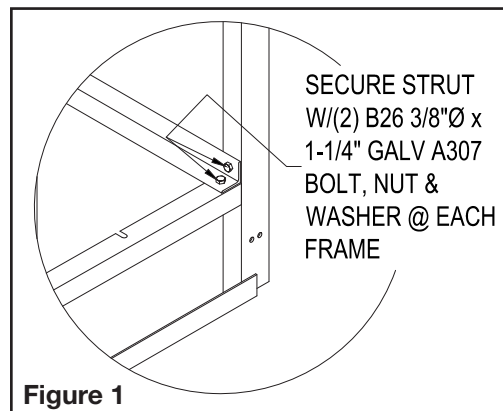

Figure 1

Step 4

Attach End Caps

a. Attach end caps to all seat plank and foot deck plank as indicated in Figure 2 with the wider flange on the bottom. Tap the channel end cap into place with a rubber mallet.

b. Mechanically fasten with two (2) B99 #8 x 3/4" tek screws through the bottom of each end cap through the bottom of the plank.

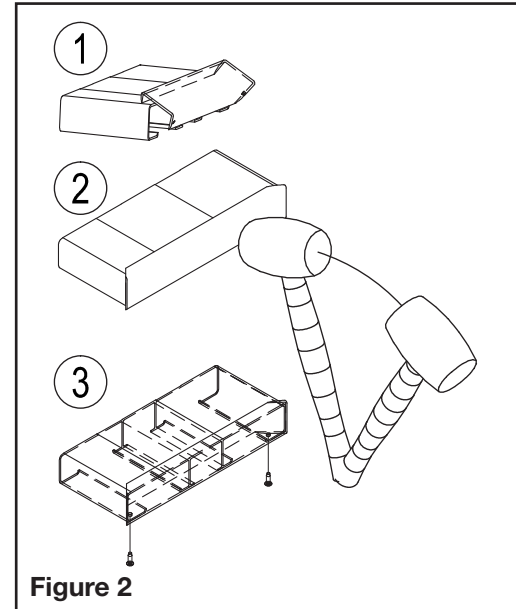

Figure 2

Step 5

Placement of Foot Deck Planks and Seat Planks

IMPORTANT: All seat planks are anodized aluminum. Foot deck planks are mill finished aluminum. Anodized planks are duller in appearance and have a cleaner finish. Mill finished aluminum is brighter in appearance. Note the difference and separate accordingly.

a. Insert two (2) tie down clip assemblies within all foot deck and seat planks at each frame location as indicated in Figure 3.

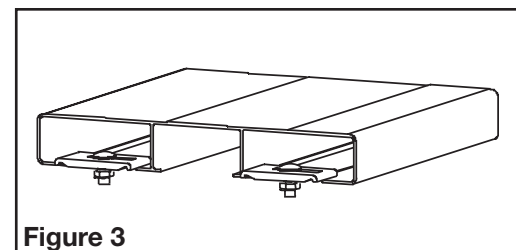

Figure 3

800-375-3141

www.allstarbleachers.com



Step 5 (continued)

b. Make sure the tie down clip assemblies are saddled over the ribs on the bottom of the plank on both sides of each tie down clip assembly as indicated in Figure 4. Do not tighten the tie down clip assemblies until all foot deck and seat planks are in place and positioned properly over all frames.

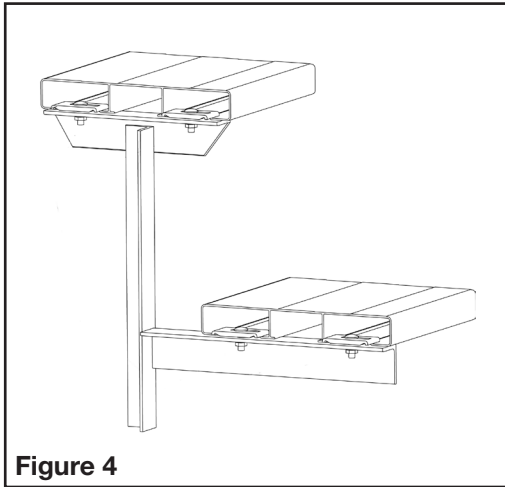

Figure 4

c. Place foot deck plank on rows 2 through 4 (if applicable) tread support. Be sure to maintain proper overhang of 1'6" off of frame (Figure 5).

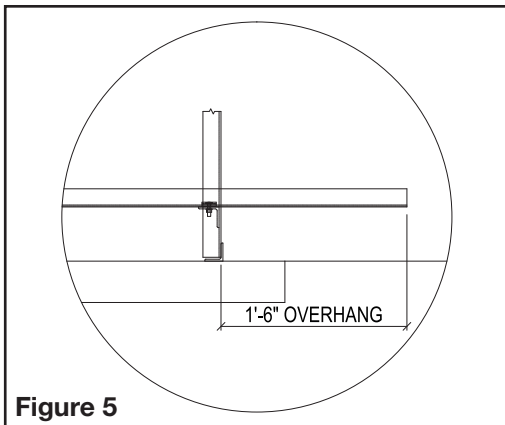

Figure 5

d. Position the lowest foot deck plank.

e. Each foot deck plank should align evenly between the back edge of the lower seat and the front edge of the upper seat support bracket as indicated in Figure 6.

Step 5 (continued)

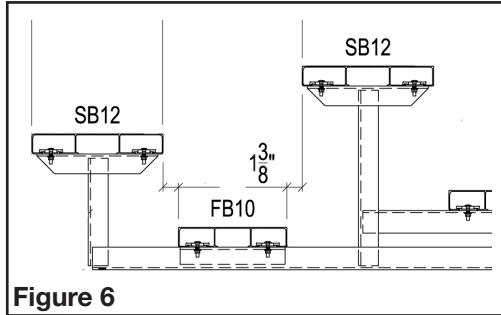

Figure 6

f. Continue installing all remaining foot deck plank.

g. Place seat plank on the top of each seat support bracket on rows 1 through 4 (if applicable) as indicated in Figure 4. Be sure to maintain proper overhang of 1'6" off of frame.

h. Once proper overhang of 1'6" has

Step 5 (continued)

been verified and tie down assemblies are properly saddled over the ribs on the bottom of all foot deck and seat plank, tighten all tie down clip assemblies.

Optional Accessories

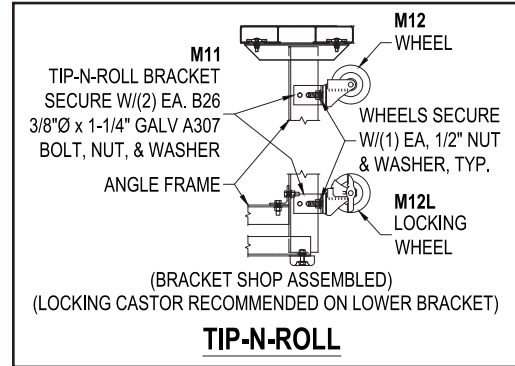

Part List for 3 Row QuickShip Bleacher

Part Number	Description	Quantity for Item Number			
		6A3S7.5	6A3S15	6A3S21	6A3S27
6A3	aluminum 3 row bleacher frame (6 x 24-FBA)	2	3	4	5
AS6	aluminum strut 6' x 1-6' Spc - AL 2 x 2 x 3/16" x 6'2"	1	1	1	1
B026	3/8" x 1 1/4" galvanized A307 bolt	4	6	8	10
B099	#8 x 3/4" hex washered tek screw	20	20	20	20
M2	tie down assembly	20	30	40	50
N04	3/8" nut	4	6	8	10
W23	3/8" flat washer	4	6	8	10
EC10	anodized end cap for 10" foot deck plank	4	4	4	4
EC12	anodized end cap for 10" seat plank	6	6	6	6
A12"7.5	1.75" x 12" anodized seat plank	3	3	3	3
M10"7.5	1.75" x 10" mill finish foot deck plank	2	2	2	2

Part List for 4 Row QuickShip Bleacher

Part Number	Description	Quantity for Item Number			
		6A3S7.5	6A3S15	6A3S21	6A3S27
6A4	aluminum 4 row bleacher frame (6 x 24-FBA)	2	3	4	5
AS6	aluminum strut 6' x 1-6' Spc - AL 2 x 2 x 3/16" x 6'2"	1	1	1	1
B026	3/8" x 1 1/4" galvanized A307 bolt	4	6	8	10
B099	#8 x 3/4" hex washered tek screw	28	28	28	28
M2	tie down assembly	28	42	56	70
N04	3/8" nut	4	6	8	10
W23	3/8" flat washer	4	6	8	10
EC10	anodized end cap for 10" foot deck plank	6	6	6	6
EC12	anodized end cap for 10" seat plank	8	8	8	8
A12"7.5	1.75" x 12" anodized seat plank	4	4	4	4
M10"7.5	1.75" x 10" mill finish foot deck plank	3	3	3	3

