

ANOD. 10" x 15'-0" SEAT PLANK (A10"15)
ATTACH W/ 2- TIE DOWN ASS'Y. (M2)

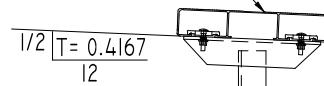

ALUM. STRUT (ASI2)
ATTACH W/ 2- 3/8 x 1" BNW (B25)

ALUM. STANDARD SURFACE BRACKET (SSBA)
ATTACH W/ 2- 1/2 x 2 3/4" WEDGE ANCHOR (B73)

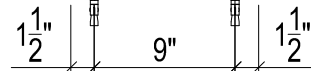

SECTION A-A

SCALE: 1" = 1'-0"

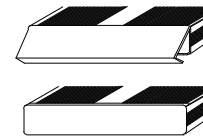

1. LOCATE THE CHANNEL END CAP AS SHOWN, WITH THE WIDER FLANGE ON BOTTOM.
2. TAP THE CHANNEL INTO PLACE WITH A RUBBER Mallet OR SOFT WOOD.
3. DRILL (2) No.8 x 9/16" TEK SCREWS W/ WEATHERCOATING THRU END CAP AND BOTTOM FLANGE OF PLANK

END CAP INSTALLATION DETAIL

PARTS LIST

QTY PER UNIT	PART NUMBER	DESCRIPTION
	SSBA15	ALUMINUM SURFACE MOUNT STANDARD TEAM BENCH x 15'-0"
1	A10"15	ANOD. 2 x 10 x 15'-0" SEAT PLANK
3	SSBA	MILL FINISH ALUMINUM STANDARD SURFACE MOUNT BRACKET
1	ASI2	MILL FINISH ALUMINUM STRUT ANGLE (AL. L2 x 2 x 3/16 x 12'-4 1/4")
2	EC10"	ANOD. ALUMINUM END CAP (FOR 10" SEAT PLANK)
6	M2	TIE DOWN ASS'Y.
6	B25	3/8 x 1" BNW
6	B73	1/2 x 2 3/4" GALV. WEDGE ANCHOR
4	B99	No. 8 x 3/4 HEX WASHERED TEK SCREW (FOR 10" END CAPS)

6550 NEW TAMPA HWY.
LAKELAND, FLORIDA 33815
FAX (813) 698-4264
(800) 875-3141
(863) 687-3141

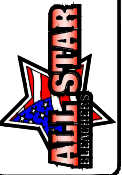

ALUMINUM SURFACE MOUNT
STANDARD TEAM BENCH x 15'-0"
SSBA15

THIS DRAWING IS THE PROPERTY OF ALL STAR BLEACHERS. THE INFORMATION CONTAINED WITHIN IS PROPRIETARY. UNAUTHORIZED REPRODUCTION THROUGH EITHER MECHANICAL OR ELECTRONIC MEANS IS PROHIBITED WITHOUT THE EXPRESS WRITTEN CONSENT OF ALL STAR BLEACHERS.

DRAWN
FOY
CHECKED

DATE

SCALE
NOTED
JOB NO.
STANDARD
SHEET
SSBA15

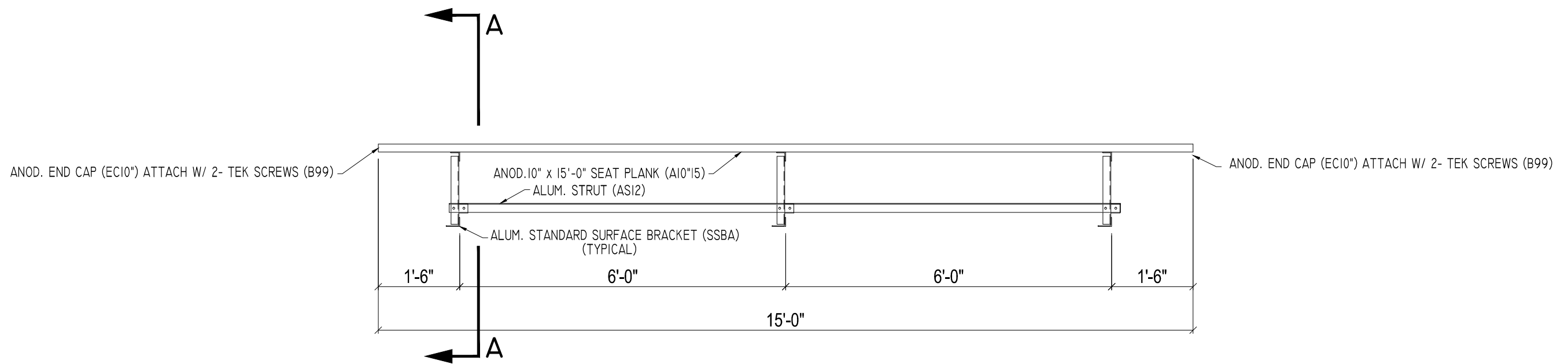

**ALUMINUM STANDARD TEAM BENCH x 15'-0" - SSBA15
(SURFACE MOUNT)**

SCALE: 1/2" = 1'-0"

ISSUE	DATE

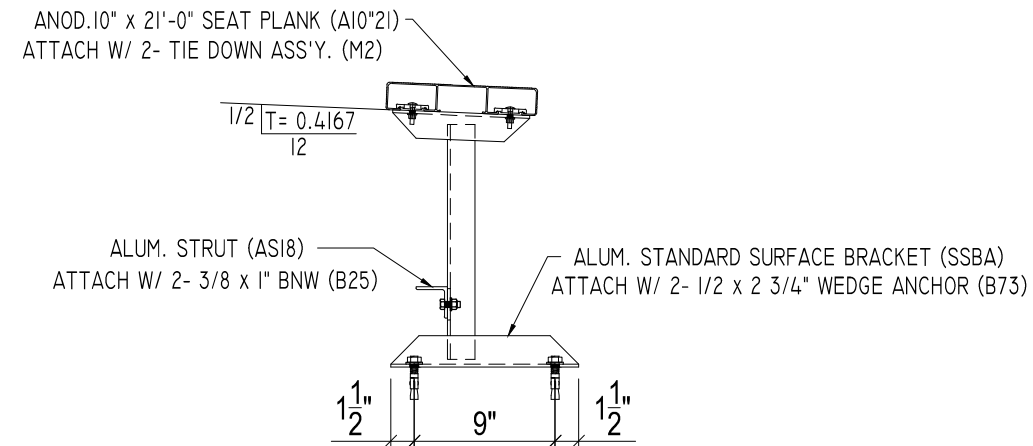

SECTION A-A

SCALE: 1" = 1'-0"

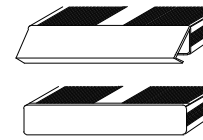

1. LOCATE THE CHANNEL END CAP AS SHOWN, WITH THE WIDER FLANGE ON BOTTOM.
2. TAP THE CHANNEL INTO PLACE WITH A RUBBER Mallet OR SOFT WOOD.
3. DRILL (2) No.8 x 9/16" TEK SCREWS W/ WEATHERCOATING THRU END CAP AND BOTTOM FLANGE OF PLANK

END CAP INSTALLATION DETAIL

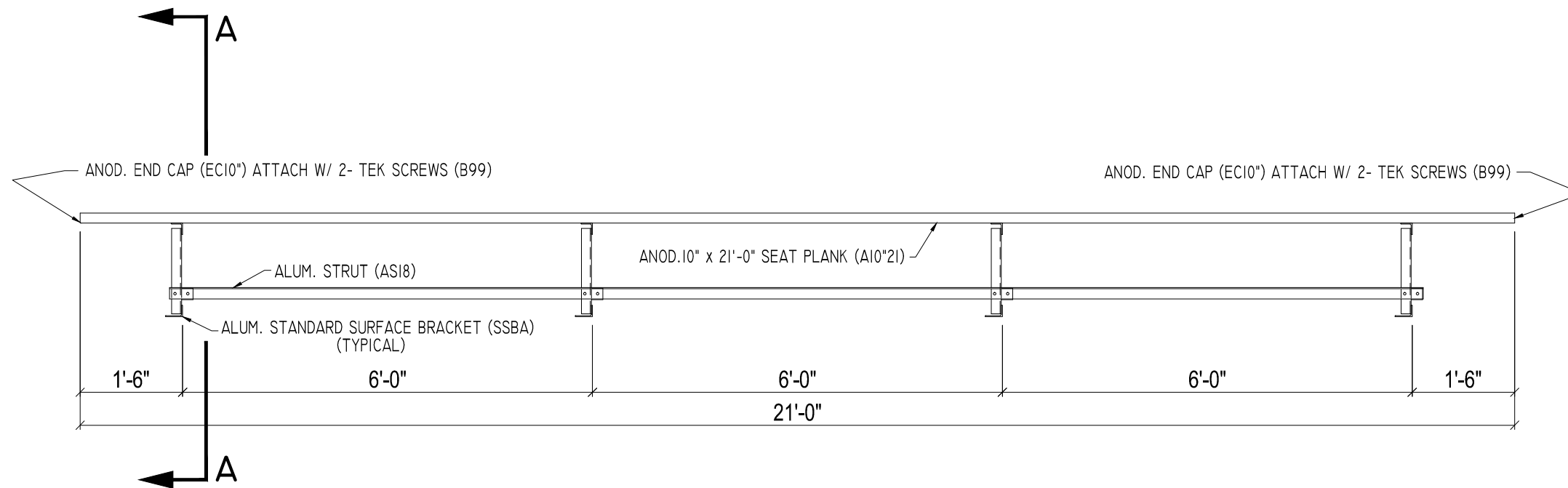

**ALUMINUM STANDARD TEAM BENCH x 21'-0" - SSBA21
(SURFACE MOUNT)**

SCALE: 1/2" = 1'-0"

PARTS LIST

QTY PER UNIT	PART NUMBER	DESCRIPTION
1	SSBA21	ALUMINUM SURFACE MOUNT STANDARD TEAM BENCH x 21'-0"
1	A10*21	ANOD. 2 x 10 x 21'-0" SEAT PLANK
4	SSBA	MILL FINISH ALUMINUM STANDARD SURFACE MOUNT BRACKET
1	AS18	MILL FINISH ALUMINUM STRUT ANGLE (AL. L2 x 2 x 3/16 x 18'-4 1/4")
2	EC10"	ANOD. ALUMINUM END CAP (FOR 10" SEAT PLANK)
8	M2	TIE DOWN ASS'Y.
8	B25	3/8 x 1" BNW
8	B73	1/2 x 2 3/4" GALV. WEDGE ANCHOR
4	B99	No. 8 x 3/4 HEX WASHERED TEK SCREW (FOR 10" END CAPS)

6550 NEW TAMPA HWY.
LAKELAND, FLORIDA 33815
FAX (813) 698-4254
(800) 875-3141
(863) 687-3141



ALUMINUM SURFACE MOUNT
STANDARD TEAM BENCH x 21'-0"
SSBA21

THIS DRAWING IS THE PROPERTY OF ALL STAR BLEACHERS. THE INFORMATION CONTAINED WITHIN IS PROPRIETARY. UNAUTHORIZED REPRODUCTION THROUGH EITHER MECHANICAL OR ELECTRONIC MEANS IS PROHIBITED WITHOUT THE EXPRESS WRITTEN CONSENT OF ALL STAR BLEACHERS.

DRAWN FOY	CHECKED
DATE	
SCALE NOTED	
JOB NO.	
STANDARD SHEET	
SSBA21	

ISSUE	DATE